



Government Of India



Micro Franchise Model TURMERIC



TELANGANA STATE FOOD
PROCESSING SOCIETY

Turmeric Powder – 100 Kg per hour



Investment – Rs.12 lakhs

Civil – 5 lakhs, Plant & Machinery – Rs. 5.5 lakhs, Power Connection- 0.7 lakh, Furniture and Fixture – 0.5 lakh, Spares – 0.2 lakh, Contingency – 0.1 lakh

Monthly Operational Expenses (60 % Utilisation)

- Revenue (480 x Rs. 7 x 25 days) - Rs. 0.84 lakh
- **Cost**
 - Labour - Rs. 20,000
 - Electricity - Rs. 10,000
 - Misc. - Rs. 5,000
 - Net Monthly Expenses - Rs. 35,000
 - Term Loan EMI Repayment - Rs. 8,000
- **Net Monthly Income - Rs. 0.41 lakh**



Bank Loan – Rs.6.6 lakhs



**Promoters Equity
Rs. 1.2 lakhs**



**Grant-in-aid / Subsidy
Rs. 4.2 lakh**

Civil Shed – 500 Sft – Rs. 5 lakhs (Rs. 500 per Sft)

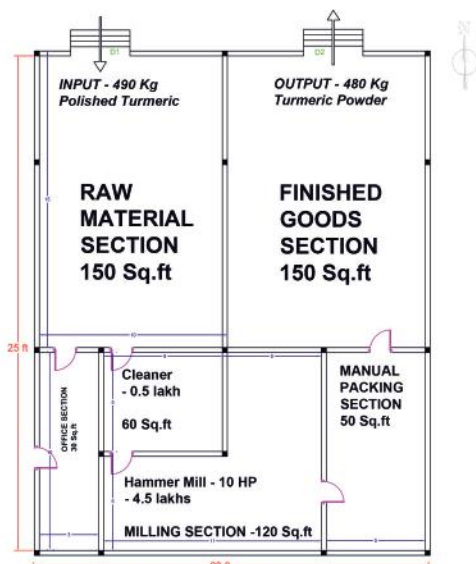

Turmeric Powder – 250 Kg per hour



Investment – Rs. 18.5 lakhs

Civil – 10 lakhs, Plant & Machinery – Rs. 7.0 lakhs, Power Connection- 0.7 lakh, Furniture and Fixture – 0.5 lakh, Spares – 0.2 lakh, Contingency – 0.1 lakh

Monthly Operational Expenses (60 % Utilisation)

- Revenue (1200 x Rs. 7 x 25 days) - Rs. 2.1 lakh
- Labour - Rs. 40,000
- Electricity -
- Misc. -Rs. 5,000
- Net Monthly Expenses - Rs. 65,000
- Term Loan EMI Repayment - Rs. 20,000
- Net Monthly Income - Rs. 1.25 lakh



Bank Loan – Rs.10.17 lakhs



**Promoters Equity
Rs. 1.85 lakhs**



Subsidy Rs. 6.48 lakh

Civil Shed – 1000 Sft – Rs. 10 lakhs (Rs. 1000 per

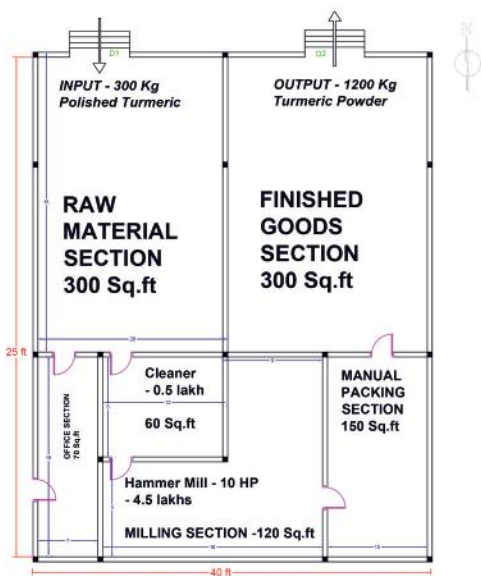

TURMERIC POWDER - 250 Kg/hr



**Bulk:
25kg**

Micro Franchises – Turmeric based

S.No.	Description	Turmeric Powder - 100 Kg per hour	Turmeric Powder - 250 Kg per hou
1	Investment (Rs. In Lakhs)	12	18.5
2	Own Contribution (Rs. In Lakhs)	1.2	1.85
3	Bank Loan (Rs. In Lakhs)	6.6	10.17
4	Government Subsidy (Rs. In lakhs)	4.2	6.48
5	Land Requirement in (Sqft)	500	1000
6	Monthly Income (Rs in lakhs)	0.41	1.25

Civil as per FSSAI

Machinery from
Empanelled Suppliers

Quality and Food Safety
norms to be maintained

