



# Micro Franchise Model MILLETS



TELANGANA STATE FOOD  
PROCESSING SOCIETY



# Millet Processing Unit – 300 Kg per hour



**Investment – Rs. 20 lakhs**

**Civil – 10 lakhs, Plant & Machinery – Rs. 8.5 lakhs, Power Connection – 1 lakh, Furniture and Fixture – 0.3 lakh, Spares – 0.1 lakh, Contingency – 0.1 lakh**

## Monthly Operational Expenses (60 % Utilisation)

- Revenue (1440 x Rs.5 x 25 days) - Rs. 1.8 lakh
- **Cost**
- Labour - Rs. 60,000
- Electricity - Rs. 15,000
- Net Monthly Expenses - Rs. 0.75 lakh
- Term Loan EMI Repayment - Rs. 16,000
- Misc. - Rs. 10,000
- **Net Monthly Income - Rs. 0.79 lakhs**



**Bank Loan – Rs. 11 lakhs lakhs**



**Promoters Equity Rs. 2 lakhs**



**Subsidy Rs. 7 lakhs**

**Civil Shed – 1000 Sft – Rs. 10 lakhs (Rs. 1000 per Sft)**

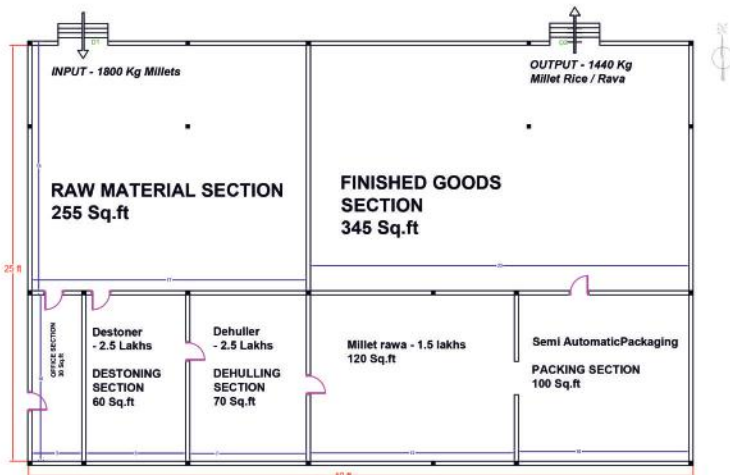

## MILLET PROCESSING UNIT - 300 Kg/hr



# Millet RTC Foods Unit – 300 Kg per hour



**Investment - Rs. 35 lakhs**

**Civil – 15 lakhs, Plant & Machinery – Rs. 17.50 lakhs, Power Connection – 1.5 lakh, Furniture and Fixture – 0.5 lakh, Spares – 0.25 lakh, Contingency – 0.25 lakh**

## Monthly Operational Expenses (60 % Utilisation)

- Revenue (1440 x Rs.8 x 25 days) - Rs. 2.88 lakh
- **Cost**
- Labour - Rs. 1 lakh
- Electricity - Rs. 20,000
- Misc. - Rs. 10,000
- Net Monthly Expenses - Rs. 1.3 lakh
- Term Loan EMI Repayment - Rs. 34,000
- **Net Monthly Income - Rs. 1.24 lakhs**



**Bank Loan – 21.5 lakhs**



**Promoters Equity Rs. 3.5 lakhs**



**Subsidy Rs. 10 lakh**

**Civil Shed – 1500 Sft – Rs. 15 lakhs (Rs. 1000 per)**

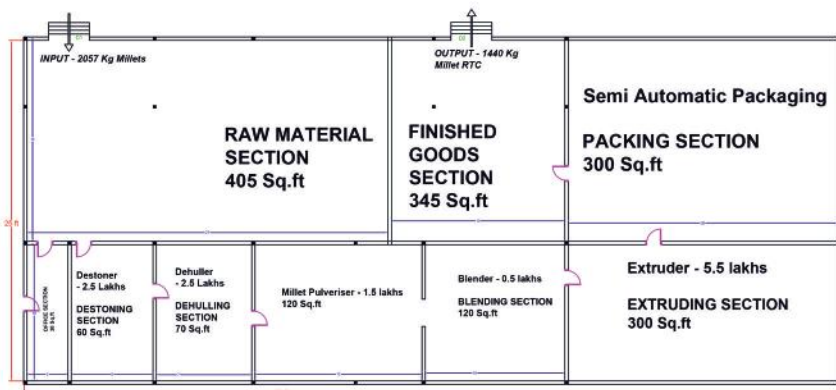

**MILLET RTC FOOD UNIT - 300 Kg/hr**





# Micro Franchises -Millet Processing

S.No.	Description	Millet – 300 Kg per hour	Millet based RTC Foods -300 Kg per hour
1	Investment (Rs. In Lakhs)	20	35
2	Own Contribution (Rs. In Lakhs)	2	3.5
3	Bank Loan (Rs. In Lakhs)	11	21.5
4	Government Subsidy (Rs. In lakhs)	7	10
5	Land Requirement (in Sqft.)	1000	1500
6	Monthly Income (Rs in lakhs)	0.79	1.24

Civil as per FSSAI

Machinery from  
Empanelled Suppliers

Quality and Food Safety  
norms to be maintained

