

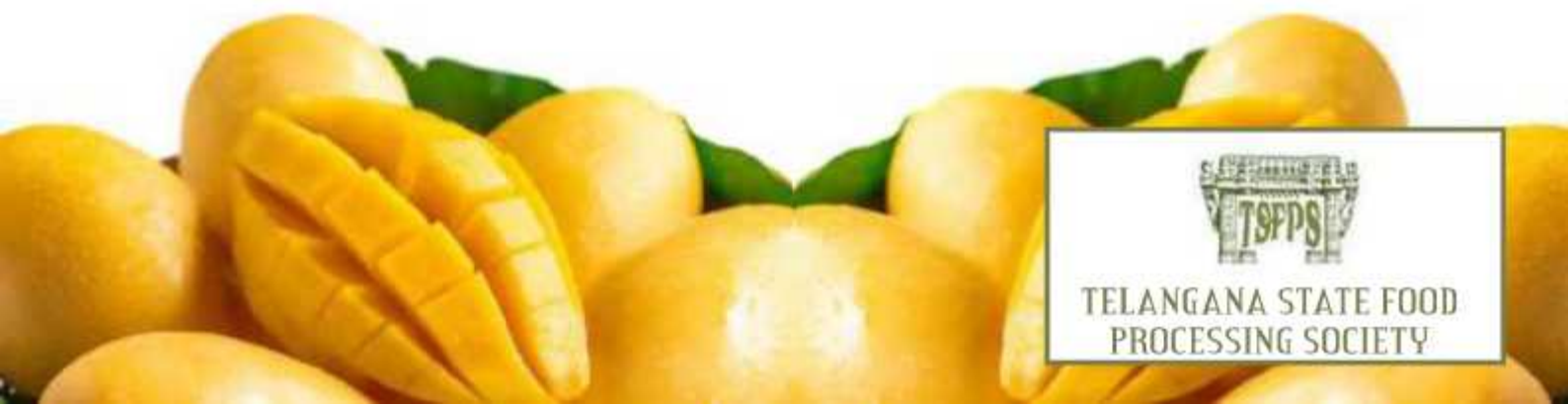

Micro Franchise Model

Mango Based Products



TELANGANA STATE FOOD
PROCESSING SOCIETY

Mango Juice / Squash – 50 Kg per hour



Investment – Rs. 7.5 Lakhs

Civil – 3 lakhs, Plant & Machinery – Rs. 3.5 lakhs, Power Connection- 0.5 lakh, Furniture and Fixture – 0.2 lakh, Spares – 0.2 lakh, Contingency – 0.1 lakh.

Monthly Operational Expenses (60% utilization)

Revenue (240 x Rs. 10 x 25 days)		0.60 lakhs
Cost		
Labor	Rs.	8,000
Electricity	Rs.	6,000
Miscellaneous	Rs.	3,000
Net monthly expenses	Rs.	17,000
Term loan repayment	Rs.	8,000
Net monthly income (Revenue - Cost)	Rs	0.35 lakhs

 **Bank Loan - Rs. 4.13 lakhs**

 **Promoters Equity Rs.0.75 lakhs**

 **Subsidy Rs. 2.63 lakhs**

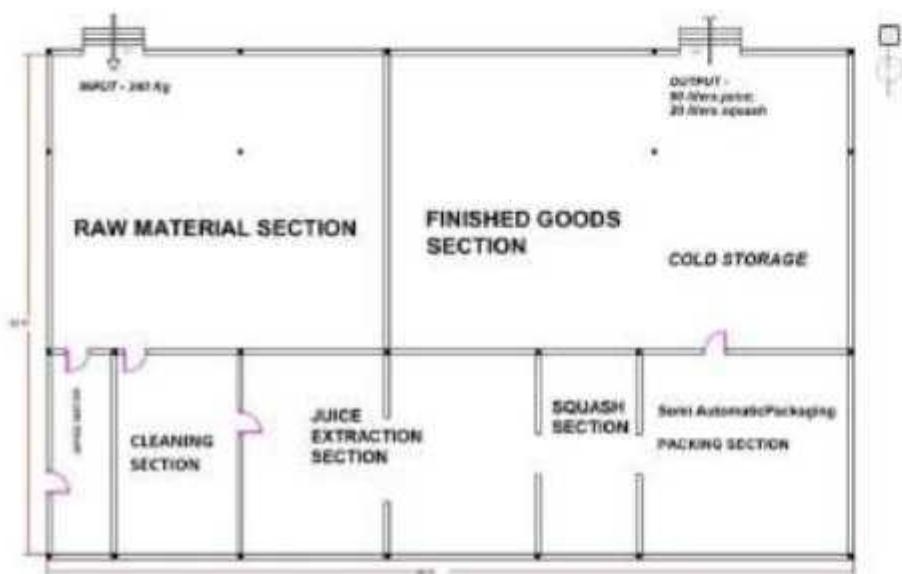

MANGO JUICE/ SQUASH - 50 Kg/hr



Amchur Unit - 100 Kg per hour



Investment – Rs. 22.0 Lakhs

Civil – 10 lakhs, Plant & Machinery – Rs. 4.5 lakhs, Power Connection- 0.7 lakh, Furniture and Fixture – 0.5 lakh, Spares – 0.2 lakh, Contingency – 0.1 lakh.

Monthly Operational Expenses (60% utilization)

Revenue (240 x Rs. 25 x 25 days)	1.5 lakhs
Cost	
Labor	Rs. 12,000
Electricity	Rs. 6,000
Miscellaneous	Rs. 2,500
Net monthly expenses	Rs. 20,500
Term loan repayment	Rs. 8,000
Net monthly income (Revenue - Cost)	Rs. 1.22 lakhs



Bank Loan - Rs. 12.10 lakhs



Promoters Equity
Rs. 2.20 lakhs



Subsidy Rs. 7.70 lakhs

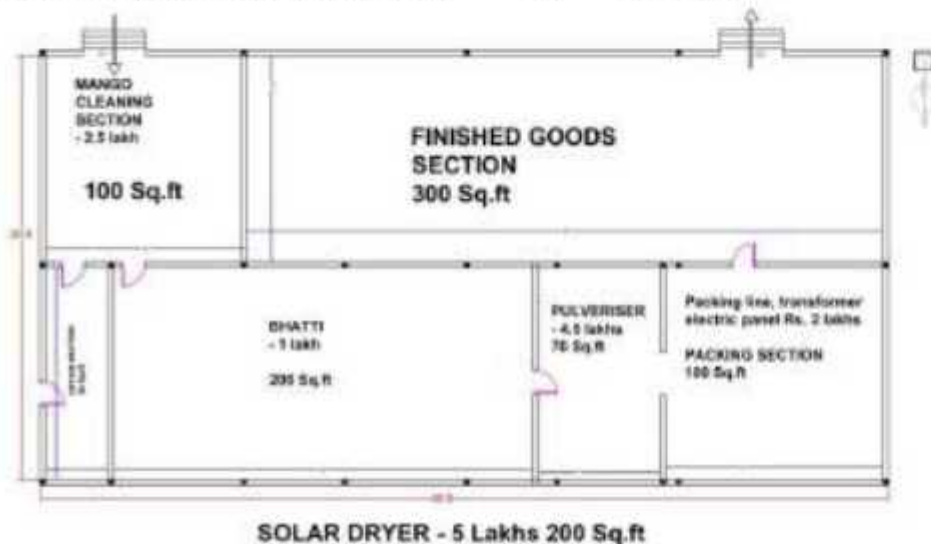

AMCHUR POWDER UNIT



Mango Jelly - 100 Kg per day



Investment – Rs 28.0 Lakhs

Civil – 10 lakhs, Plant & Machinery – Rs. 14 lakhs, Power Connection- 1.5 lakh, Furniture and Fixture – 1 lakh, Spares – 0.75 lakh, Contingency – 0.75 lakh.

Monthly Operational Expenses (60% utilization)

Revenue (100 Kg jelly x Rs. 80 x 25 days)		2.00 lakhs
Cost		
Labor	Rs.	50,000
Electricity	Rs.	10,000
Miscellaneous	Rs.	3,000
Net monthly expenses	Rs.	63,000
Term loan repayment	Rs.	18,000
Net monthly income (Revenue - Cost)	Rs	1.19 lakhs

 **Bank Loan - Rs. 15.40 lakhs**

 **Promoters Equity Rs.2.80 lakhs**

 **Subsidy Rs. 9.80 lakhs**

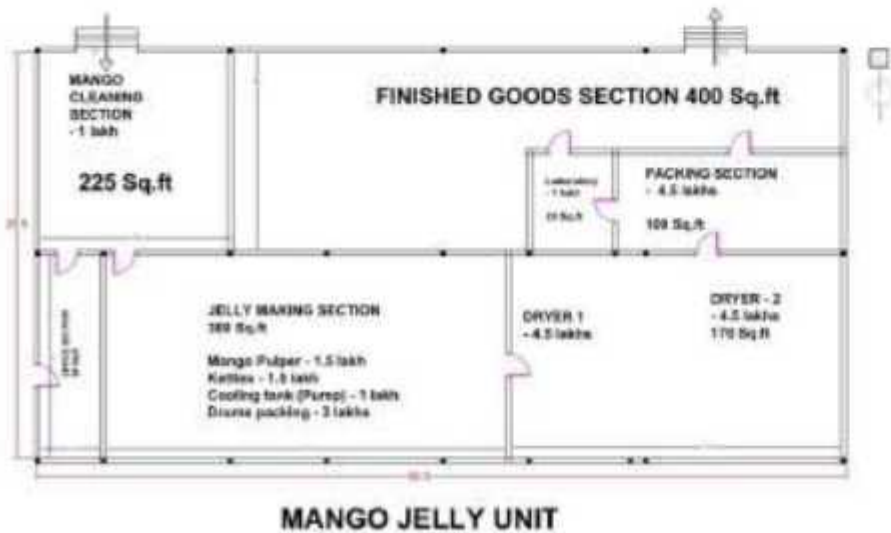



Make in
Telangana



Telangana State Food Processing Society
Dept. of Industries, Telangana

KVIB Building, 2nd, Masab Tank, Hyderabad, Telangana - 500022
Phone: 040 2331 9273

Micro Franchises - Mango Based Processing Units

S. No	Description	Mango Juice/ Squash	Amchur	Mango Jelly
1	Investment (Rs. Lakhs)	7.5	22	28
2	Own contribution (Rs. Lakhs)	0.75	2.20	2.80
3	Bank Loan (Rs. Lakhs)	4.13	12.10	15.40
4	Government (Grant in-aid) (Rs. Lakhs)	2.63	7.70	9.80
5	Land Requirement in (Sq. ft)	300	1000	1000
6	Monthly Income (Rs. Lakhs)	0.35	1.22	1.19

Civil as per FSSAI

Machinery from
Empanelled Suppliers

Quality and Food Safety
norms to be maintained

